

# INTEGRAL

2046UAP125R26-28S30 4XM8

EAN 4031582456844



BETTER MOBILITY. BETTER LIFE.



Image may differ from the original product

## PERFORMANCE

Roll performance	● ● ● ○ ○
Movement noise	● ● ● ○ ○
Attrition	● ● ● ● ○
Corrosion resistance	● ● ● ○ ○

## CORE ATTRIBUTES

Product name	Integral
Type	Swivel castor with central, total lock
Standard	similar EN12531- Hospital Bed Castors
Load capacity at 3 km/h	150 kg
Load capacity at 4 km/h	150 kg
Load capacity Static	300 kg
Temperature range (Minimum)	-30 °C
Temperature range (Maximum)	80 °C
Overall height	158 mm
Overall weight	0.975 kg
Certification	Tested and monitored by TÜV Süd

## WHEEL

Body material	Polyamide
Tread material	Polyurethane, injected
Bearing	Precision ball bearing
Threadguards	Integrated threadguard
Diameter	125 mm
Tread width	32 mm
Hardness of tread (D)	42 Shore D

## HOUSING

Material fork	Steel sheet, medium
Fork shape	Closed
Swivel bearing	Precision ball bearing
Offset	35 mm
Swivel radius	97.5 mm
Swivel interference	195 mm

## FITTING

Brake cam	hex cam
Fitting type	Stem with cam hole for profile bars
Bolt diameter	28 mm
Bolt length	96 mm



IF  
Design  
Award



Red Dot  
Design  
Award

# INTEGRAL

2046UAP125R26-28S30 4XM8

EAN 4031582456844



BETTER MOBILITY. BETTER LIFE.

## TECHNICAL DRAWINGS

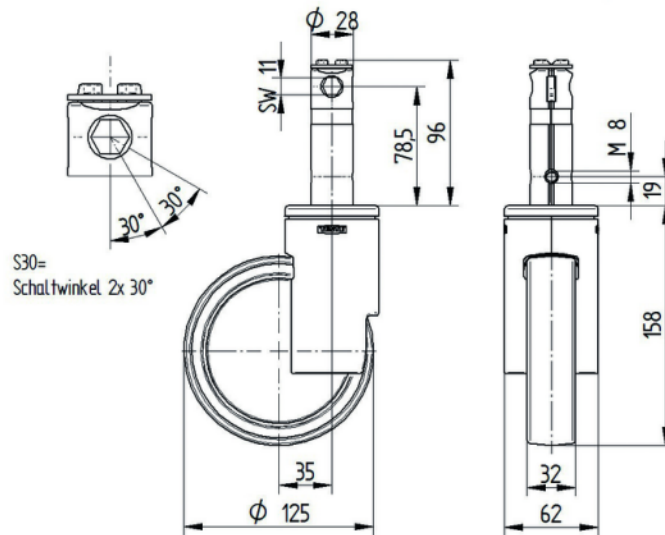

IF  
Design  
Award



Red Dot  
Design  
Award